

10322/DR/27 Z

KEY

	FILTER DRAIN
	CARRIER DRAIN
	CARRIER AND FILTER DRAINS IN COMBINED TRENCH
	COMBINED DRAINAGE AND KERB BLOCKS
	DITCH
	GULLY
	DIRECTION OF FLOW
	NEW CHAMBER
	HEADWALL
	POLLUTION TRAP
	CHANNEL BLOCK TYPE B DUCT
	COMMUNICATIONS DUCT
	COMMUNICATIONS DRAMPIT
	Foul Drain Proposed
	Foul Drain Existing
	DITCH INVERT LEVEL
	CULVERT
	LIGHTING COLUMN JOINTING CHAMBERS

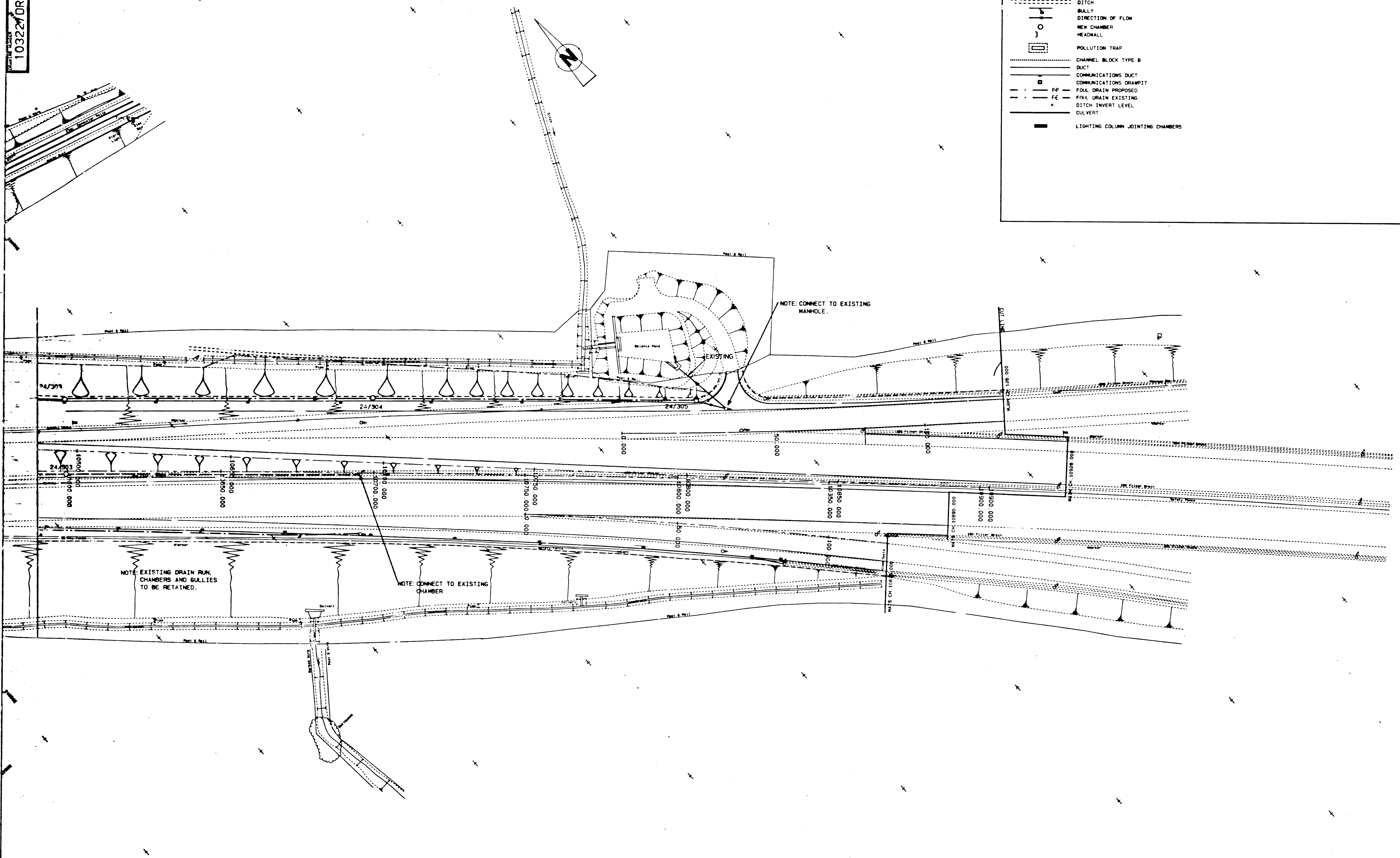

REV	DATE	BY	CHKD	PA	DATE
1	MAY 95	DR	CH	PA	DATE
2	FEB 96	DR	CH	PA	DATE
3	MAY 96	DR	CH	PA	DATE
4	MAY 96	DR	CH	PA	DATE

NOTES

1. DRAIN, CHAMBERS AND GULLY TYPES AND LEVELS ARE GIVEN IN THE DRAINAGE SCHEDULES.
2. FOR DETAILS OF DITCH TYPES AND LININGS SEE EARTHWORKS DRAWINGS.
3. FOR DETAILS OF DUCTS REQUIRED AS WORKS FOR STATUTORY UNDERTAKERS SEE SERVICES DRAWINGS.
4. ALL COVER LEVELS GIVEN IN THE SCHEDULES ARE APPROXIMATE FINAL LEVELS TO BE FIXED TO SUIT SURROUNDING SURFACES.

M20 IMPROVEMENT JUNCTION 5-8

ROADWORKS
DRAINAGE & SERVICE DUCTS
CH. 10590.000

DRAWN BY	CHECKED BY	PASSED BY	DATE	SCALE
BOS	KEZ	MD	JUL '90	1:500

THE DEPARTMENT OF TRANSPORT
South East Regional Office

Travers Morgan & Partners
East Grinstead

TRAVERS MORGAN

DRAWING NUMBER: 10322/DR/27
REV: Z