

Building areas:

- 1. Inter Modal yard = 6.54 Ha
- 2. Class B1 offices & rail served warehousing = 11,371 sq m/122,400 sq ft
- 3. Rail served warehousing = 191,862 sq m/2,065,200 sq ft
- 4. Rail connected warehousing = 170,500 sq m/1,835,400 sq ft

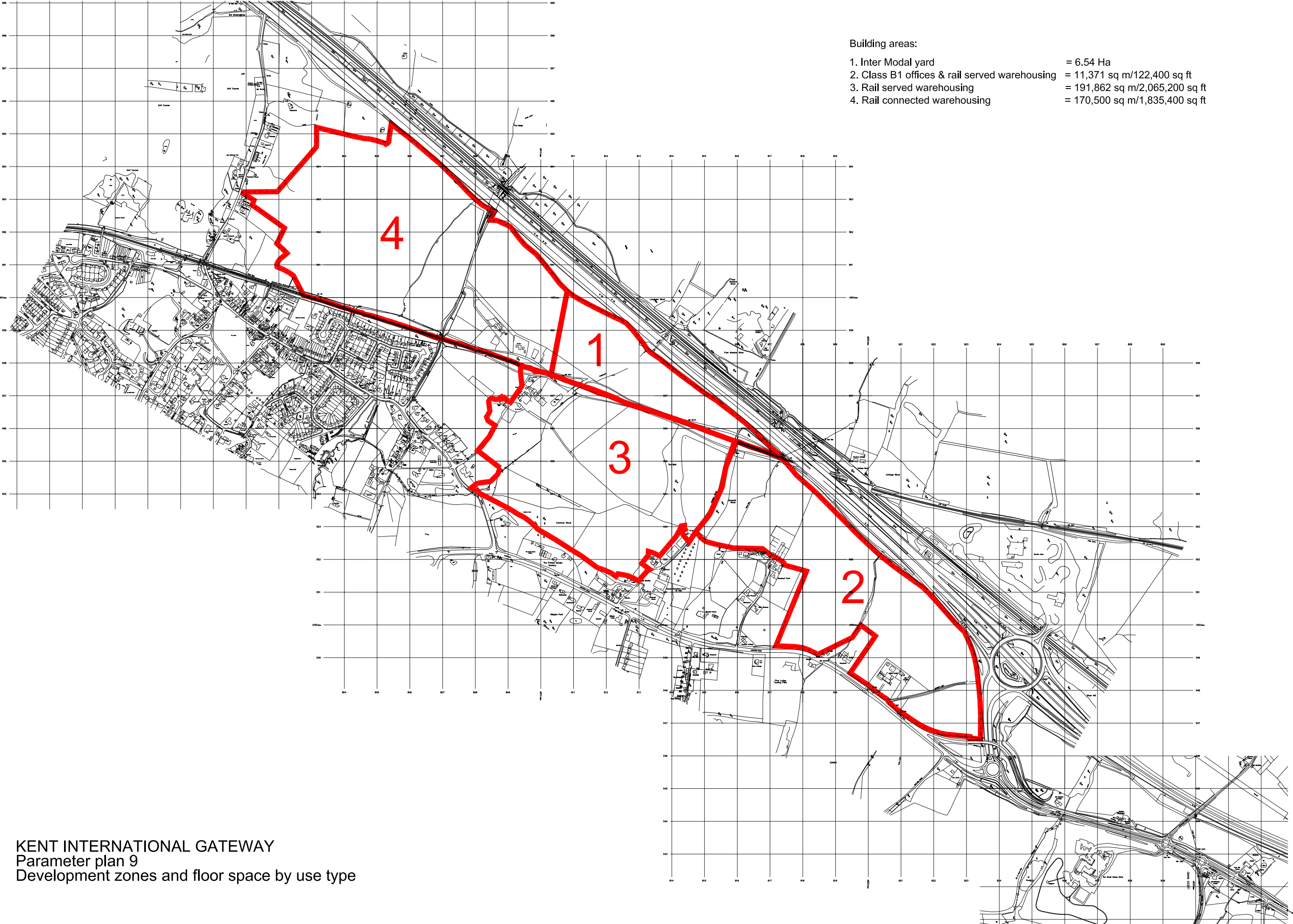

KENT INTERNATIONAL GATEWAY
Parameter plan 9
Development zones and floor space by use type